

**THE  
MET**

THE METROPOLITAN  
MUSEUM OF ART

**THE GREAT HALL  
DIGITAL DISPLAY SCREENS**

NYC LANDMARKS  
PRESERVATION COMMISSION  
SUBMISSION

**BEYER  
BLINDER  
BELLE**

REVISION 1  
SEPTEMBER 13, 2023

# 1. EXISTING CONDITIONS AND HISTORY

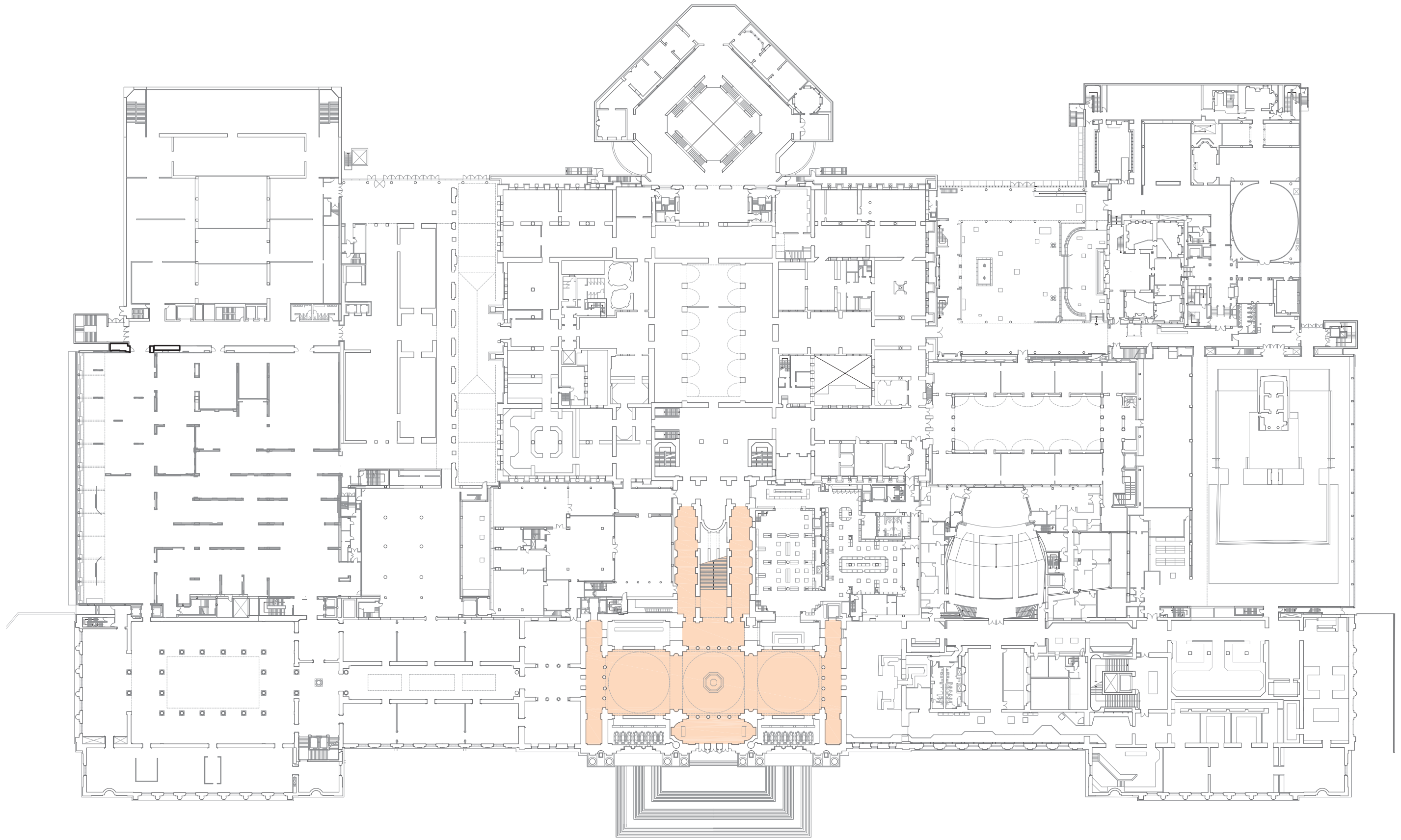

SHADED AREA SHOWS  
EXTENT OF INTERIOR LANDMARK

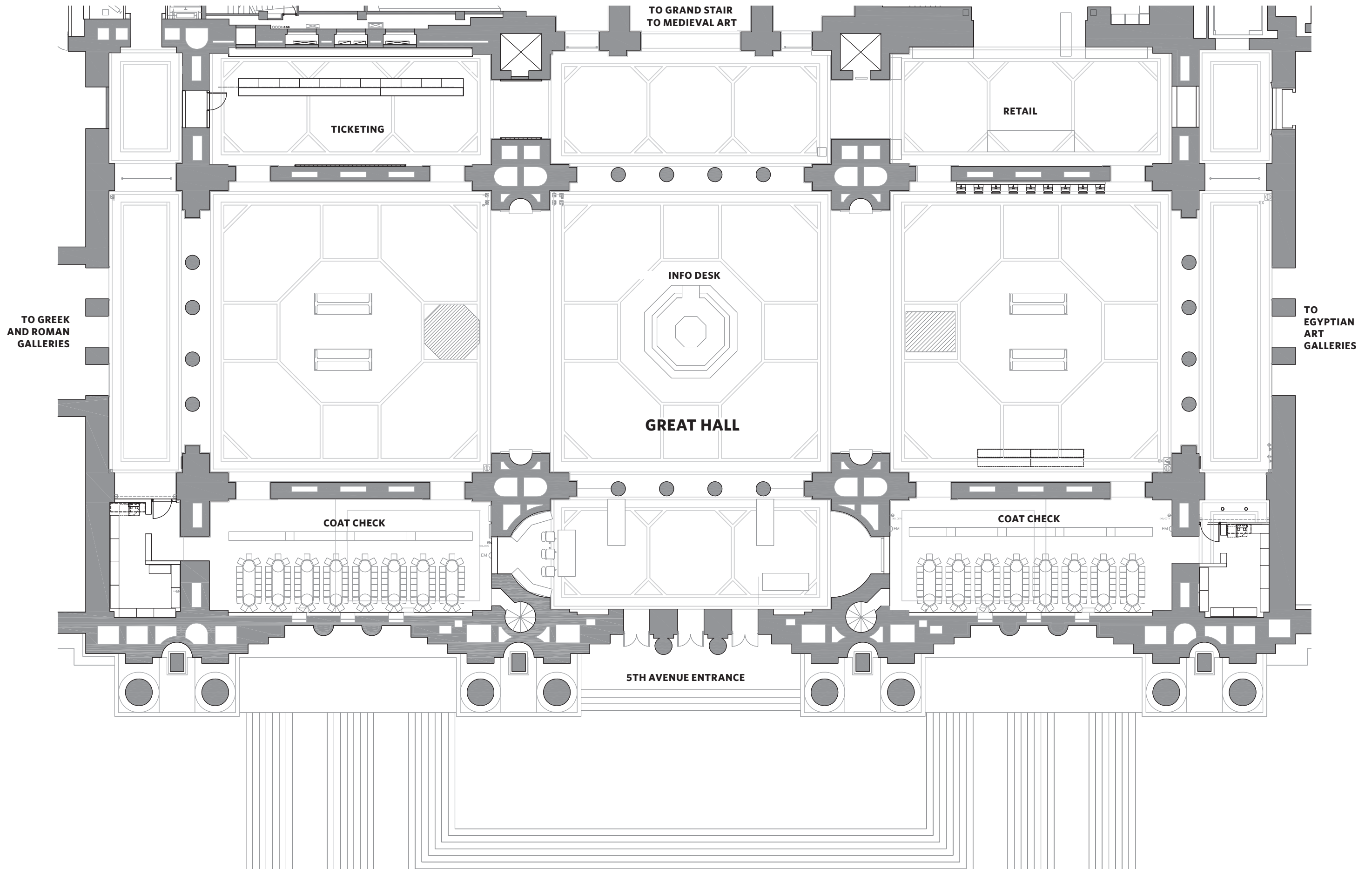

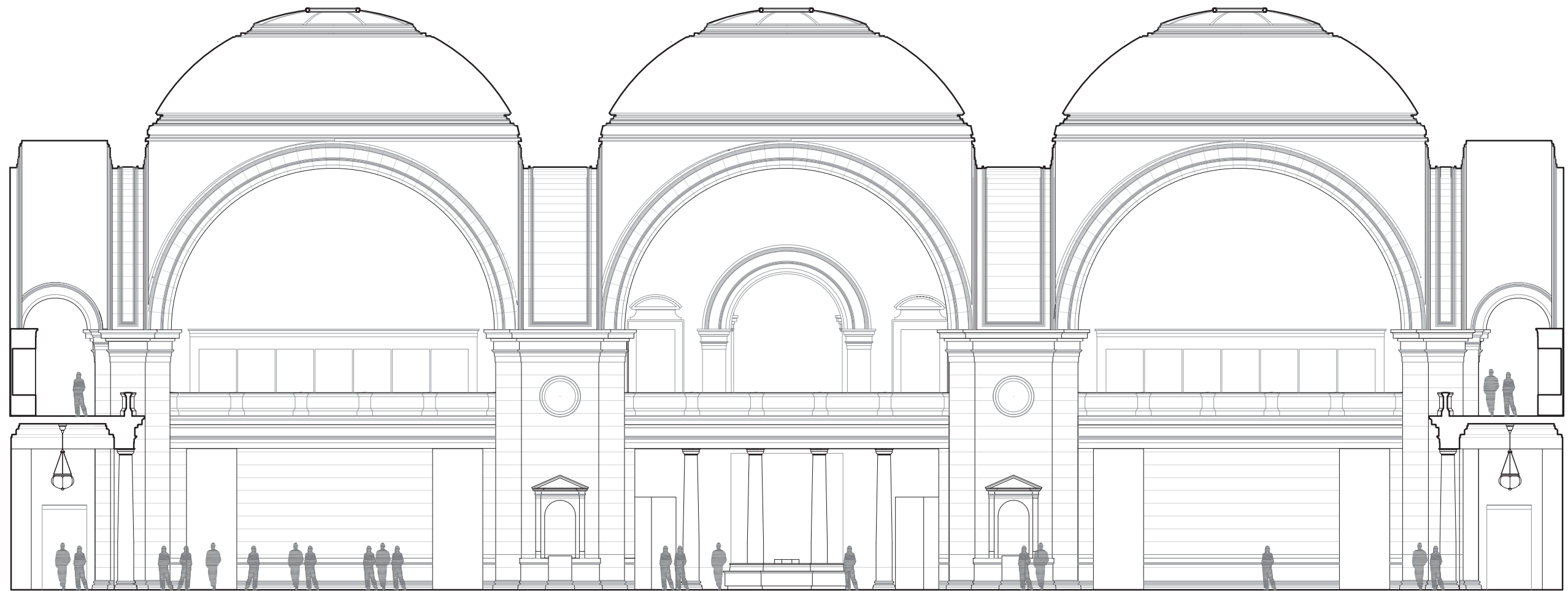

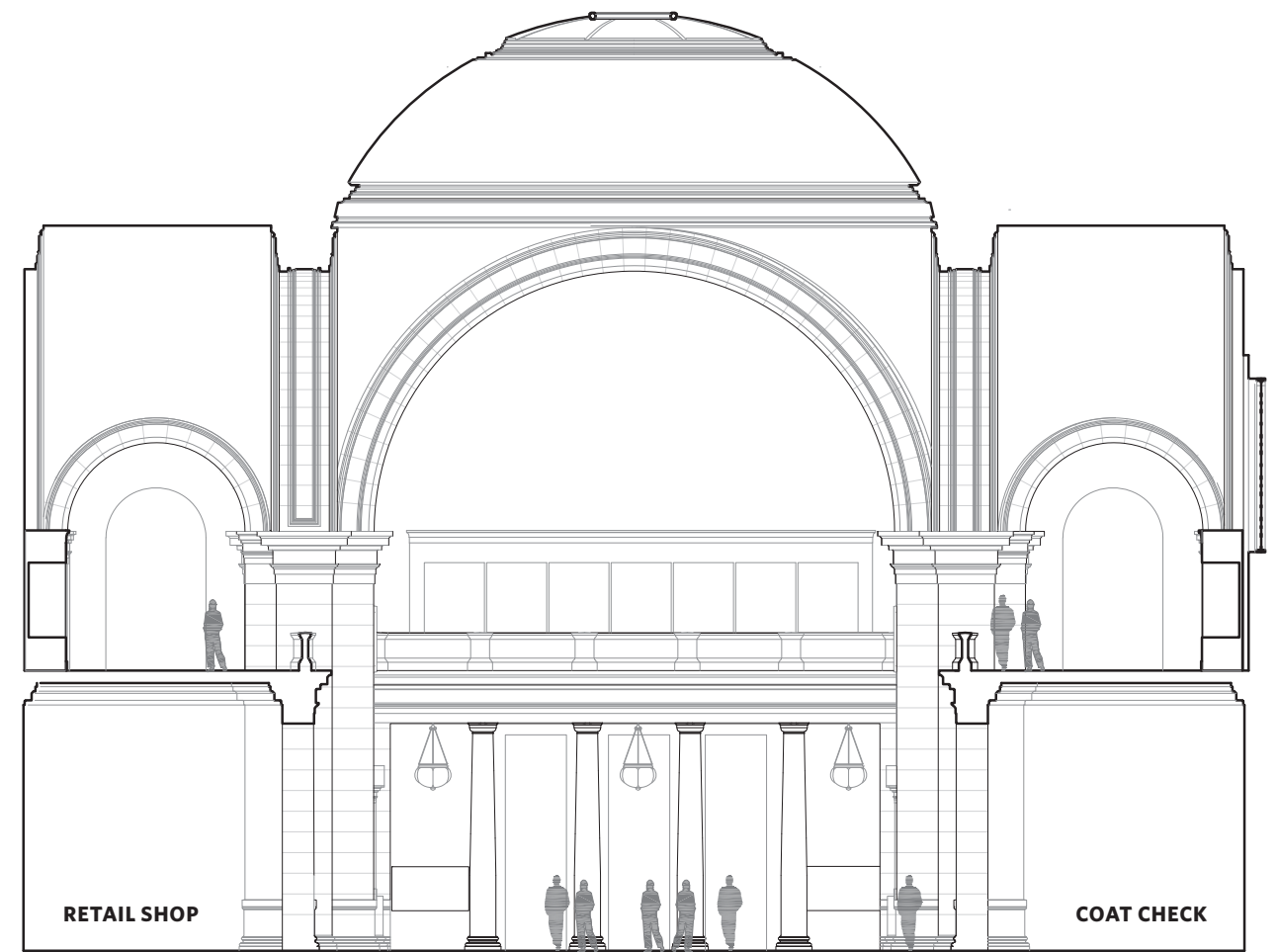
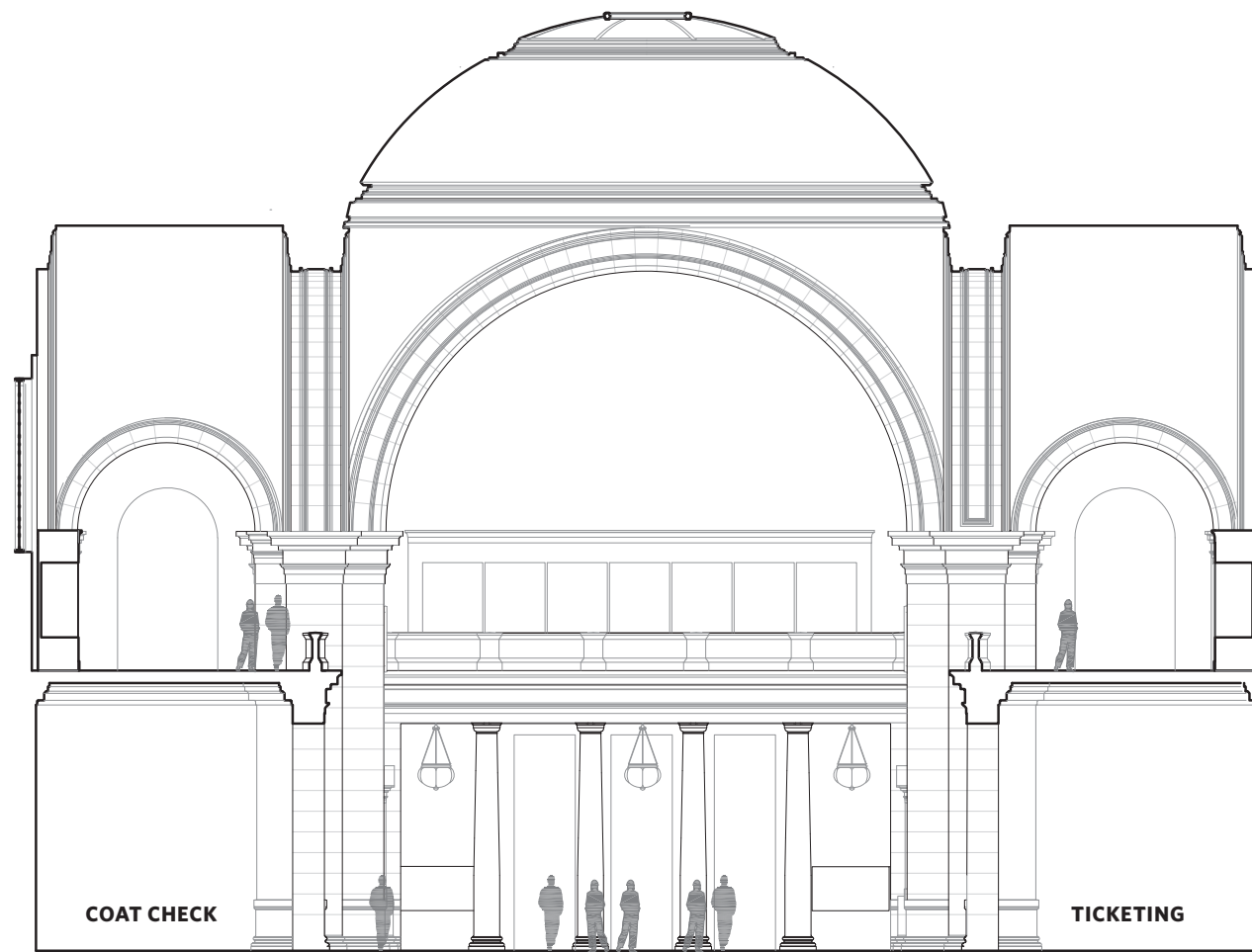



**GREAT HALL, LOOKING SOUTH, 1902**

The space was used as an entrance hall and a gallery.



**GREAT HALL, LOOKING SOUTH, 1907**

McKim Mead and White altered the original skylights to provide more natural light.



**GREAT HALL, LOOKING NORTH, 1917**

New light fixtures were added.



**GREAT HALL, LOOKING NORTH, C. 1940'S**

The light post fixtures on the balcony parapet have been removed.



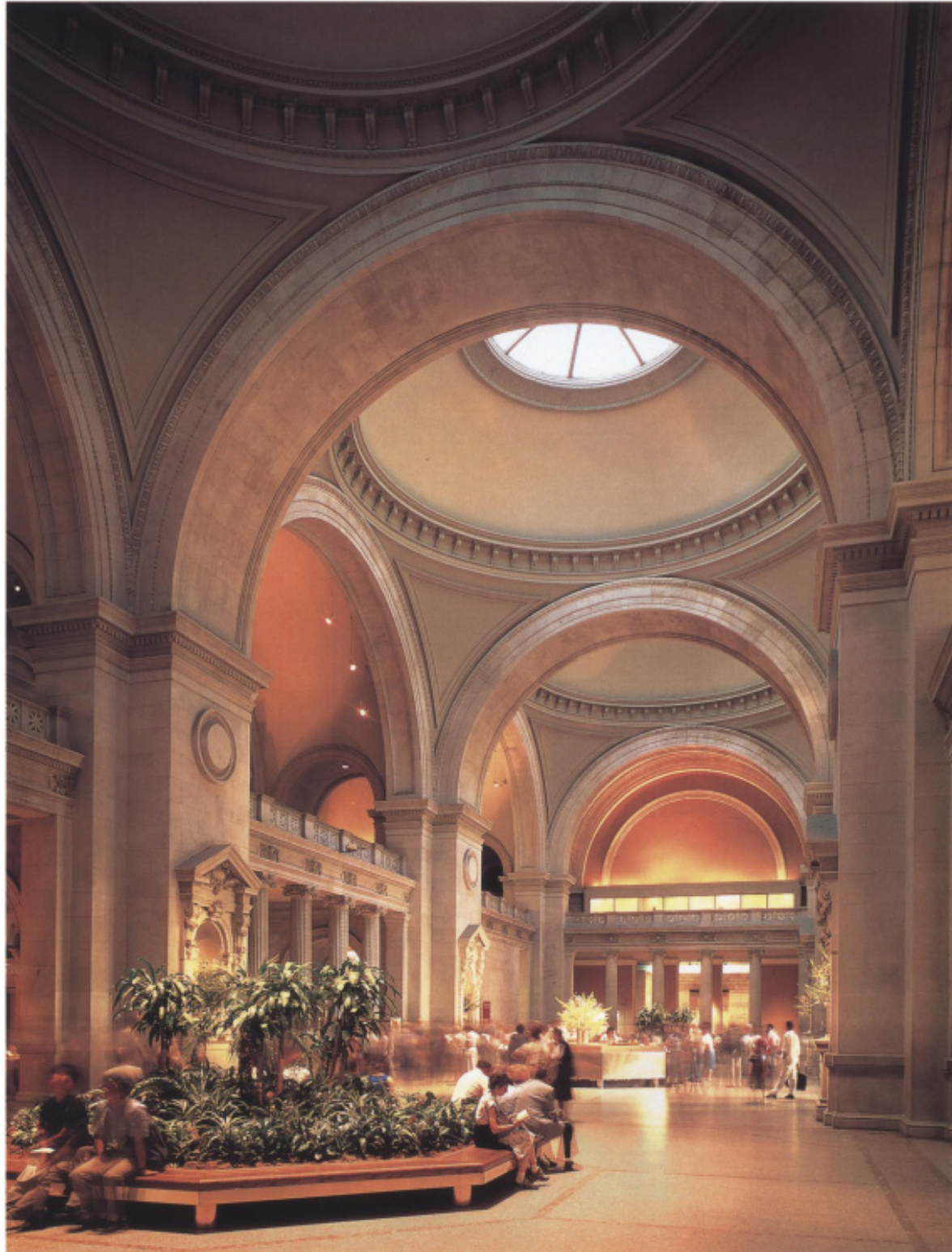

**GREAT HALL, LOOKING NORTH, 1992**

Kevin Roche John Dinkeloo Associates' renovation in 1970 for Museum's 100<sup>th</sup> Anniversary, including updating the lighting and adding a bold color palette. The current north and south coatrooms and their doorway openings into the Great hall were created at this time.



**GREAT HALL, LOOKING NORTH, 2023**



**GREAT HALL, NORTH END, 2012**

From the 1970's until 2020, there were three sets of admission ticket desks in the Great Hall, at each of the north, south and west entrances to the galleries.

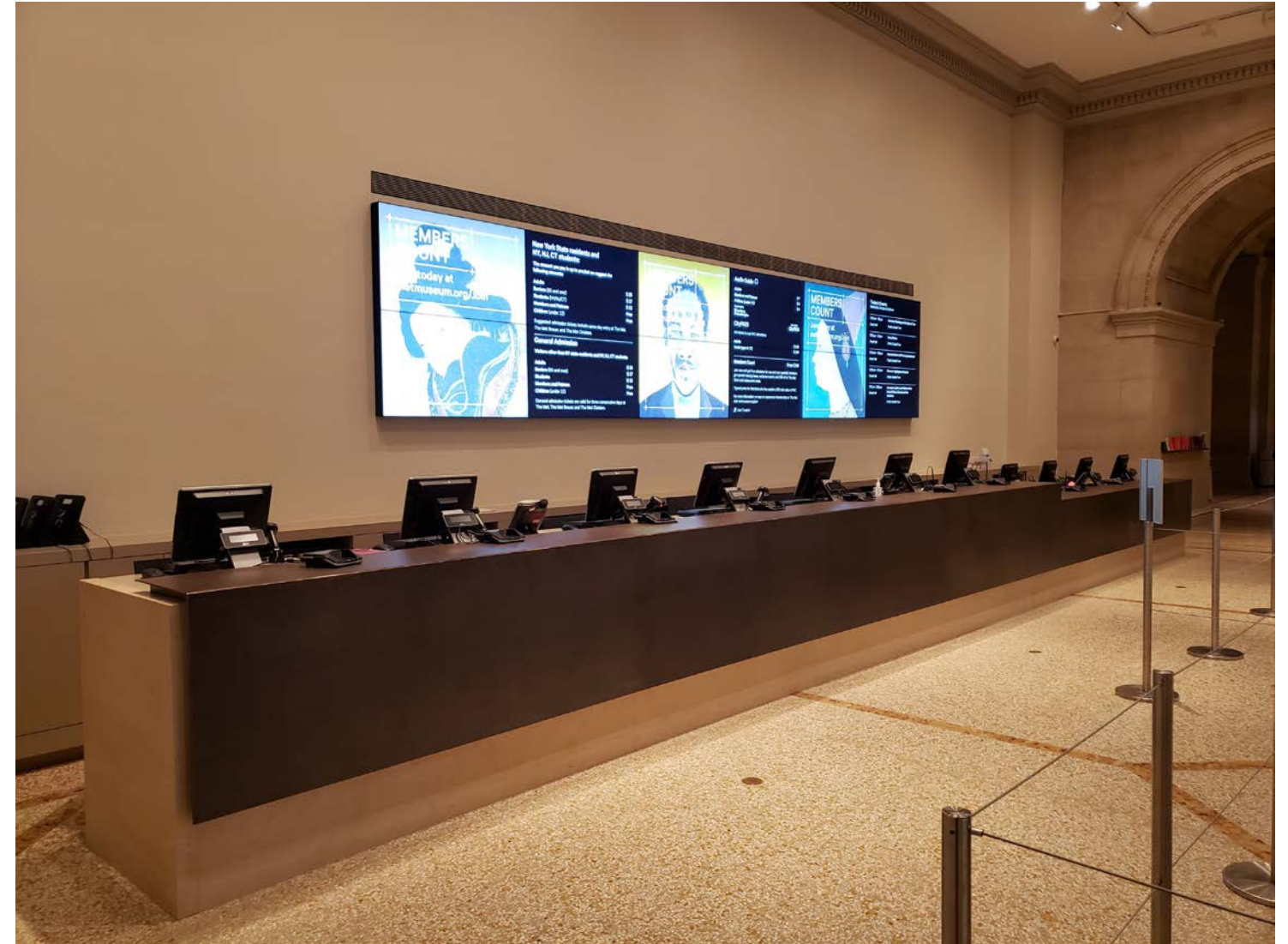

**TICKETING HALL, 2021**

In 2020 the ticket desks were removed and a new ticketing hall was created under the balcony in the southwest quadrant in what had been a retail shop space.

## 2. PROPOSED DESIGN

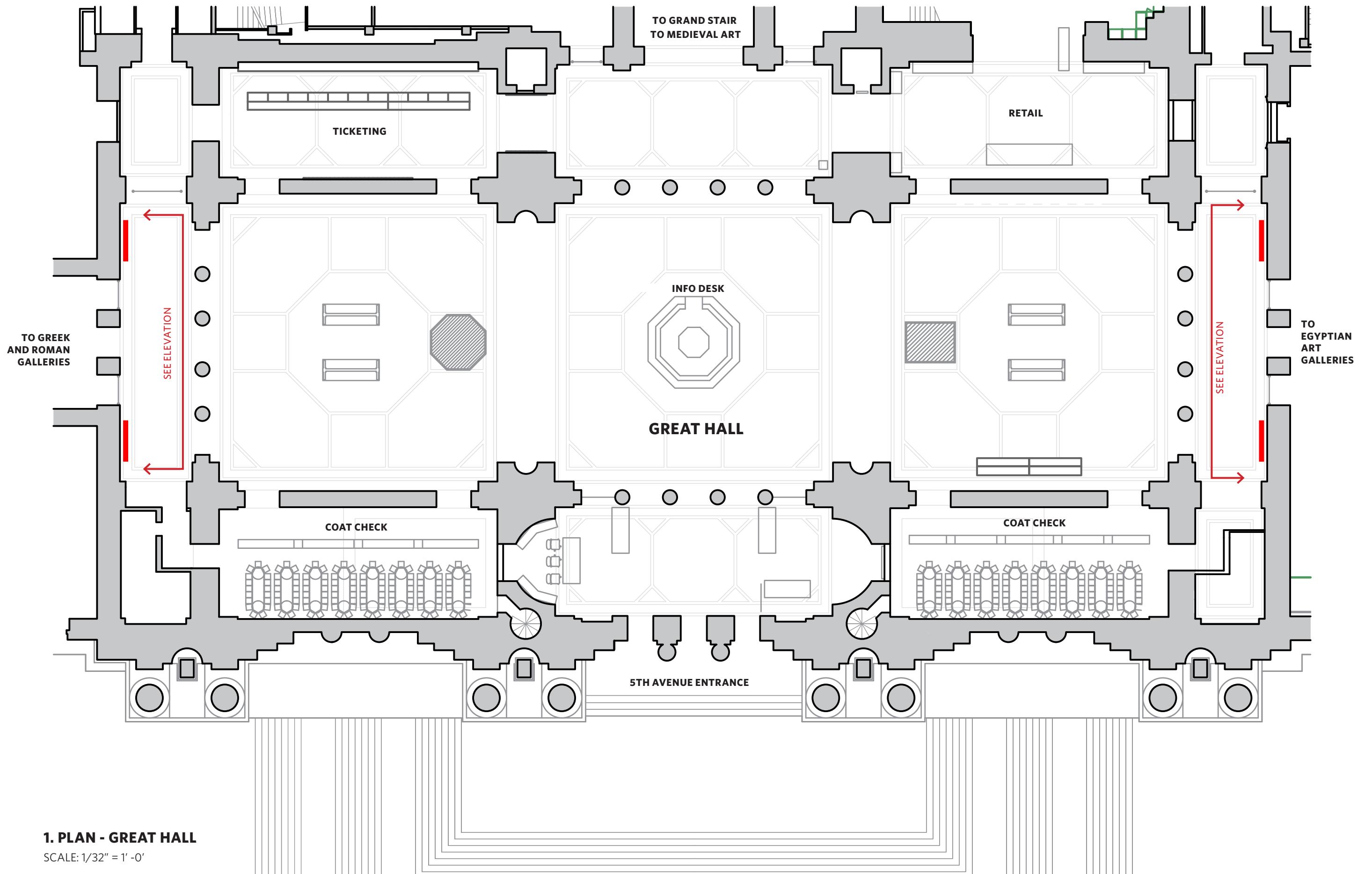

**1. PLAN - GREAT HALL**

SCALE: 1/32" = 1' - 0"

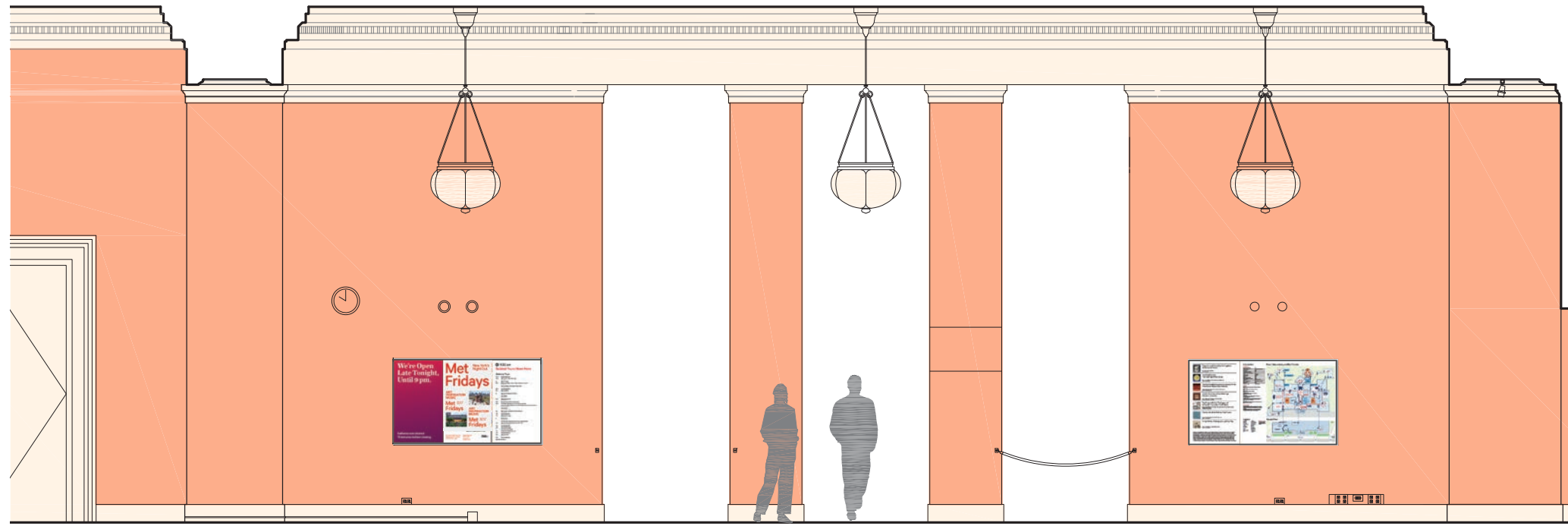

**PROPOSED SCREEN**

**PROPOSED SCREEN**

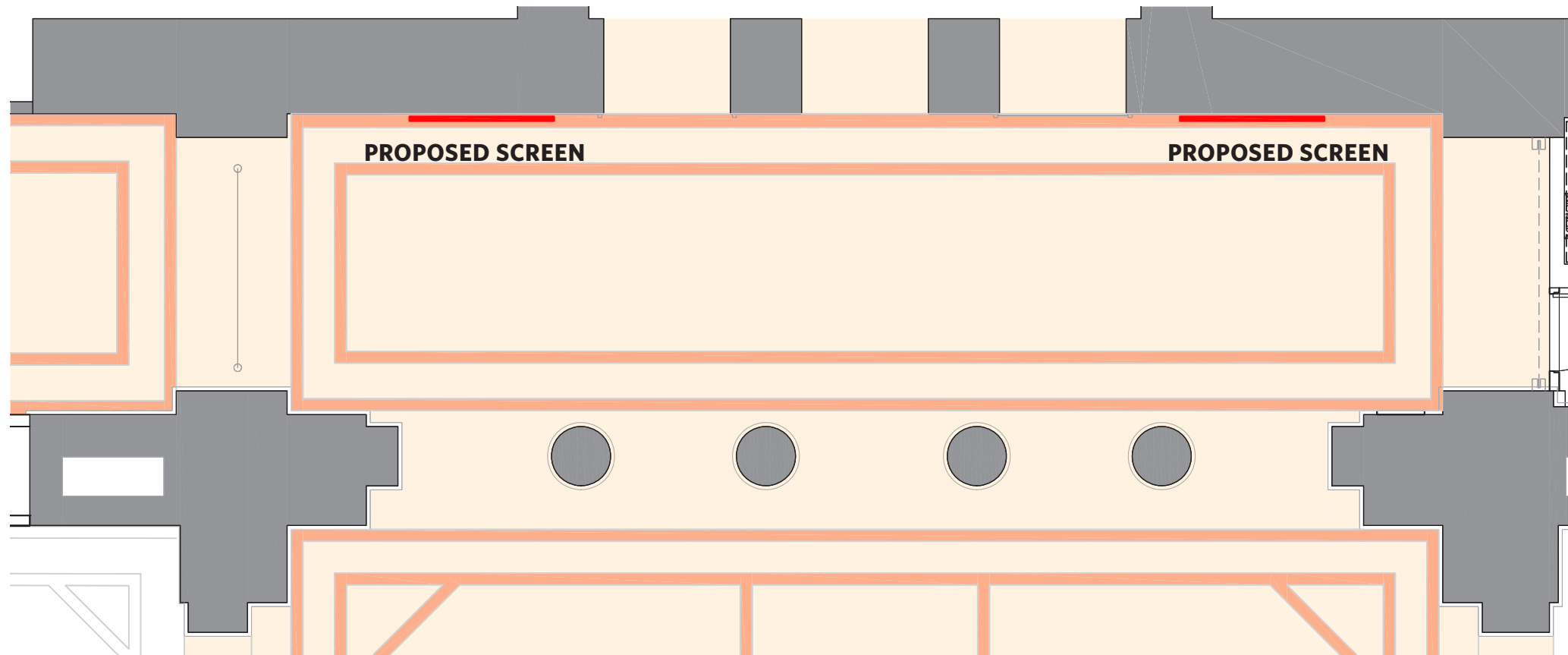

**PROPOSED SCREEN**

**PROPOSED SCREEN**

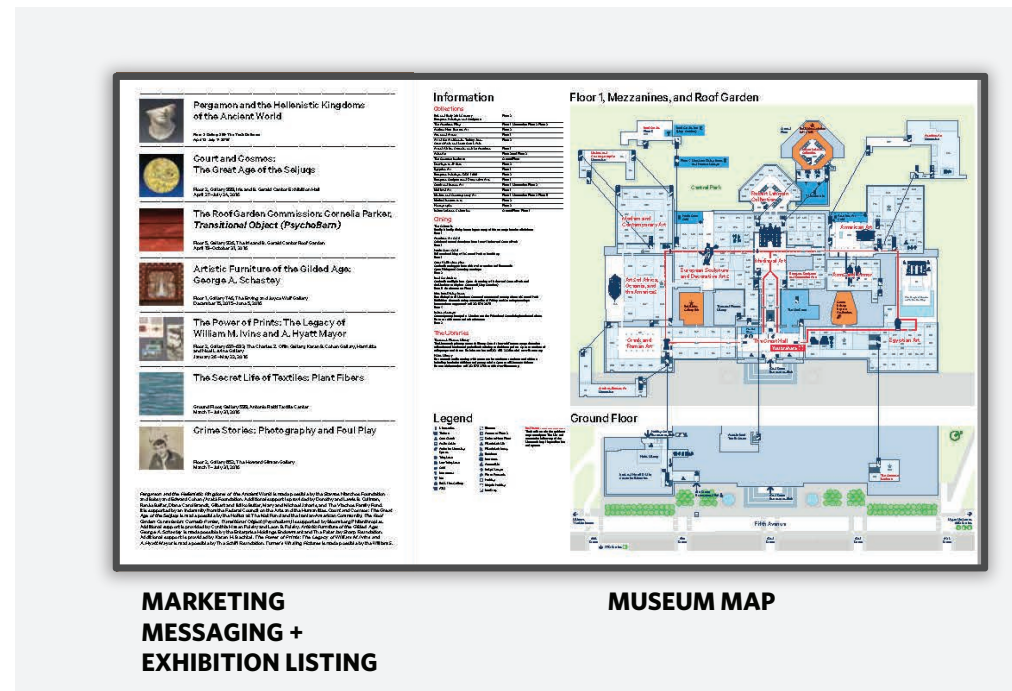
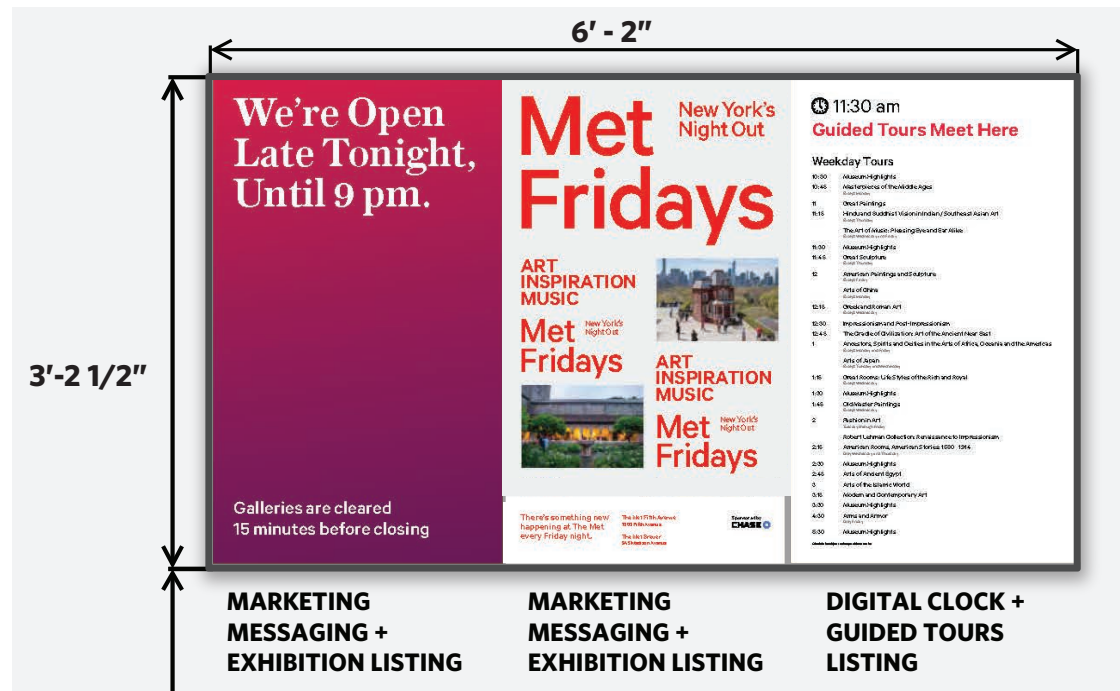

**SAMPLE DISPLAY SCREEN CONTENT**

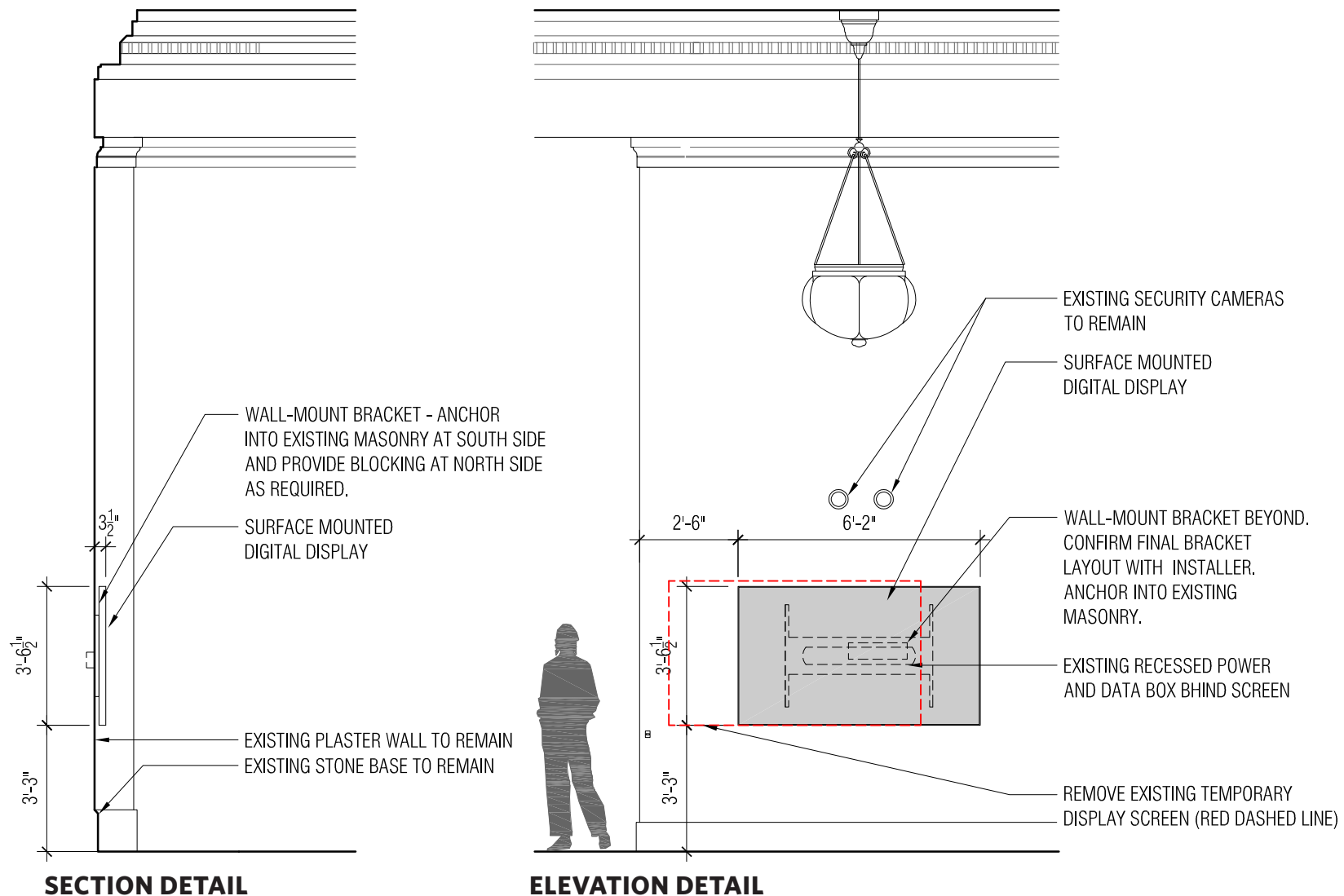

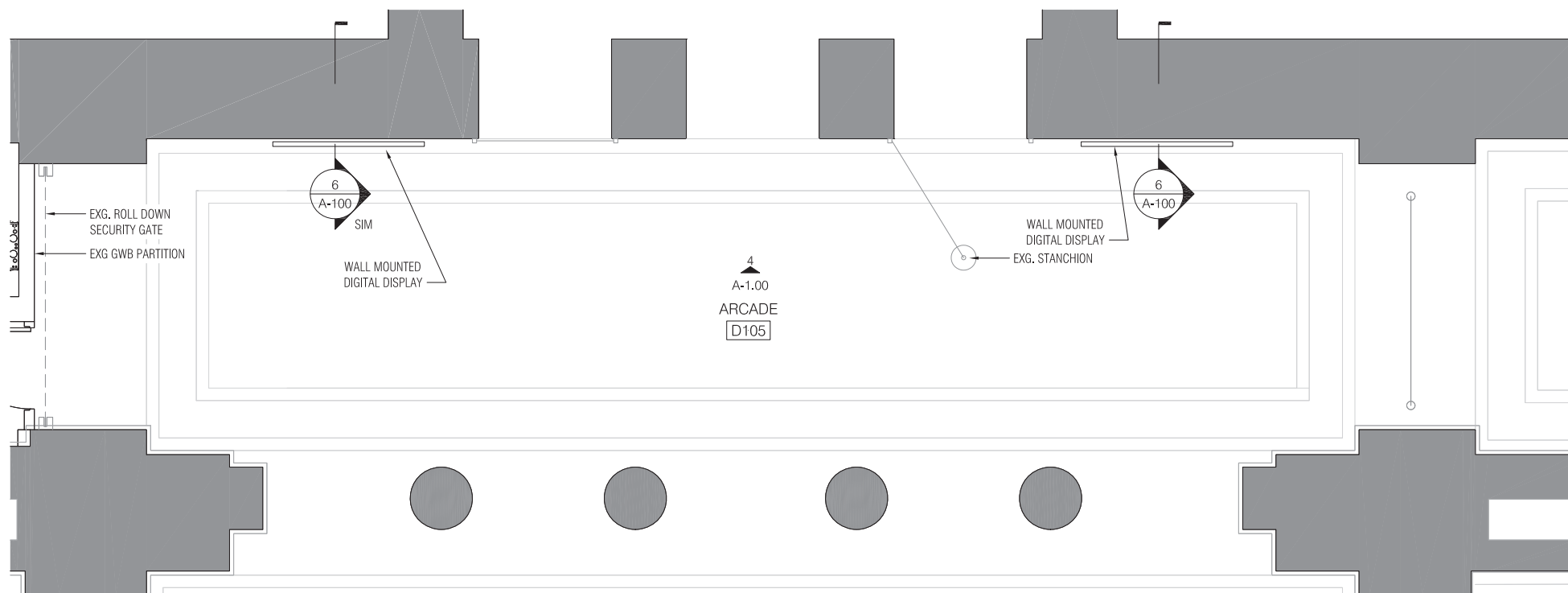
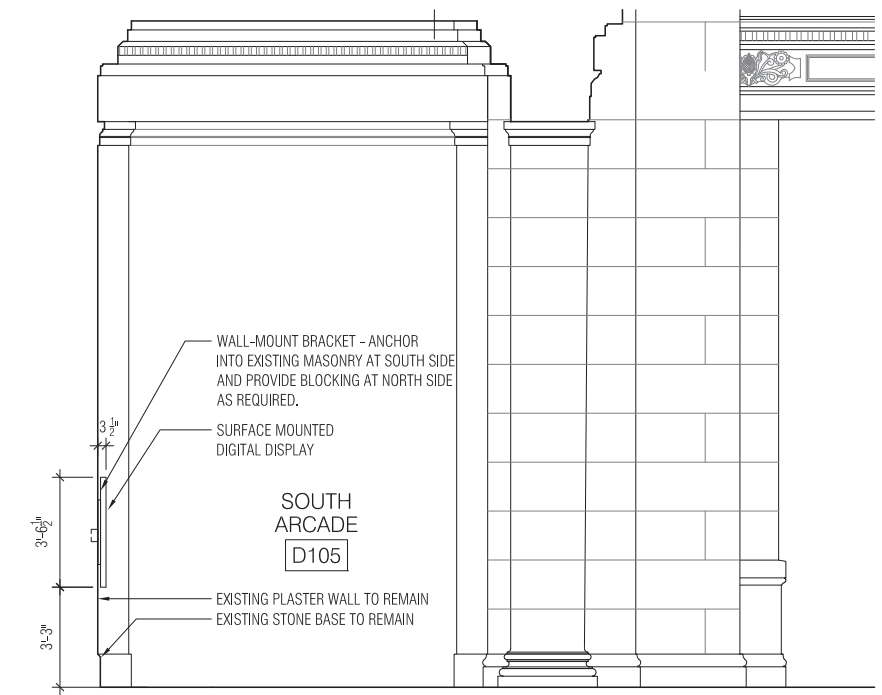
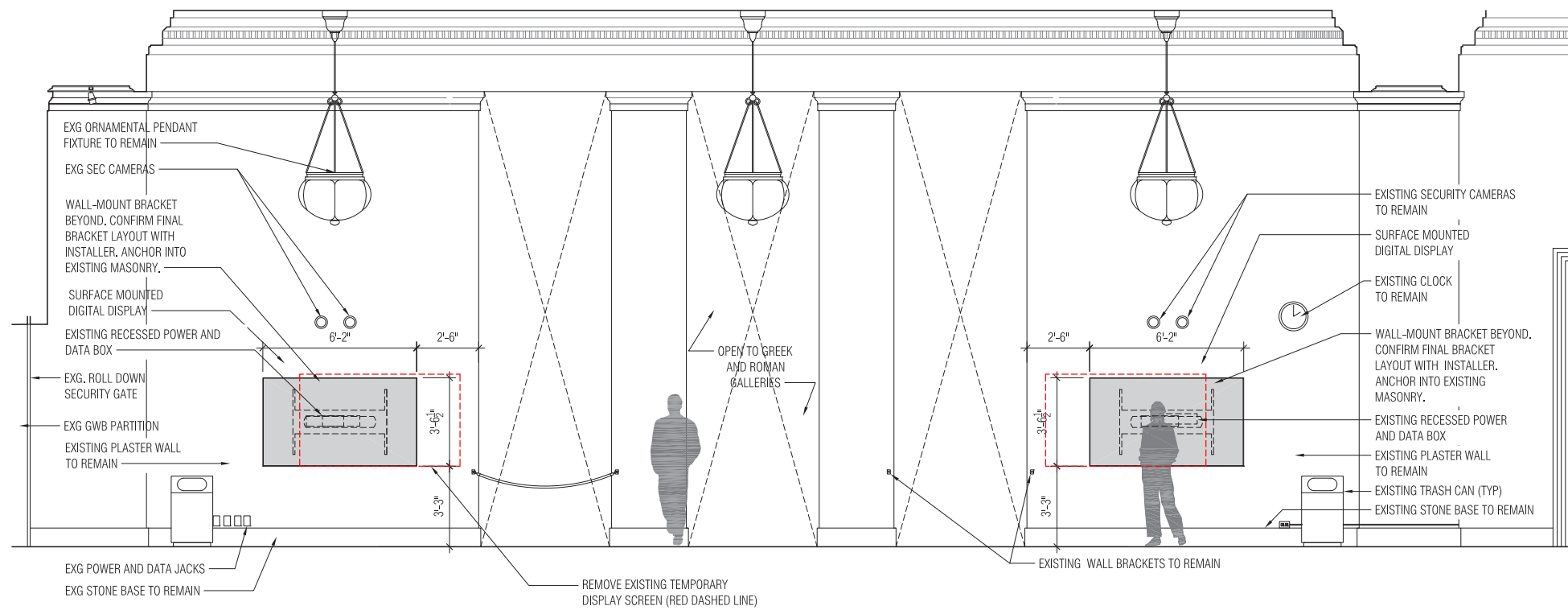

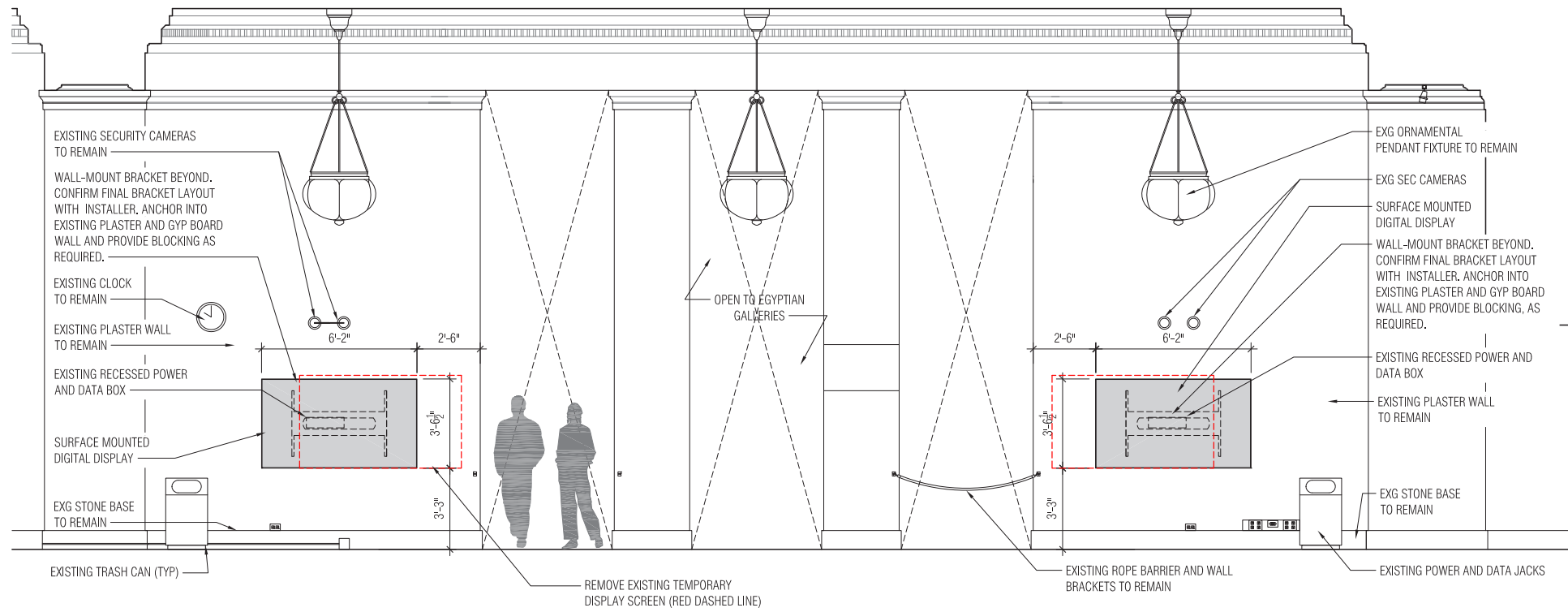

NORTH ARCADE - D107

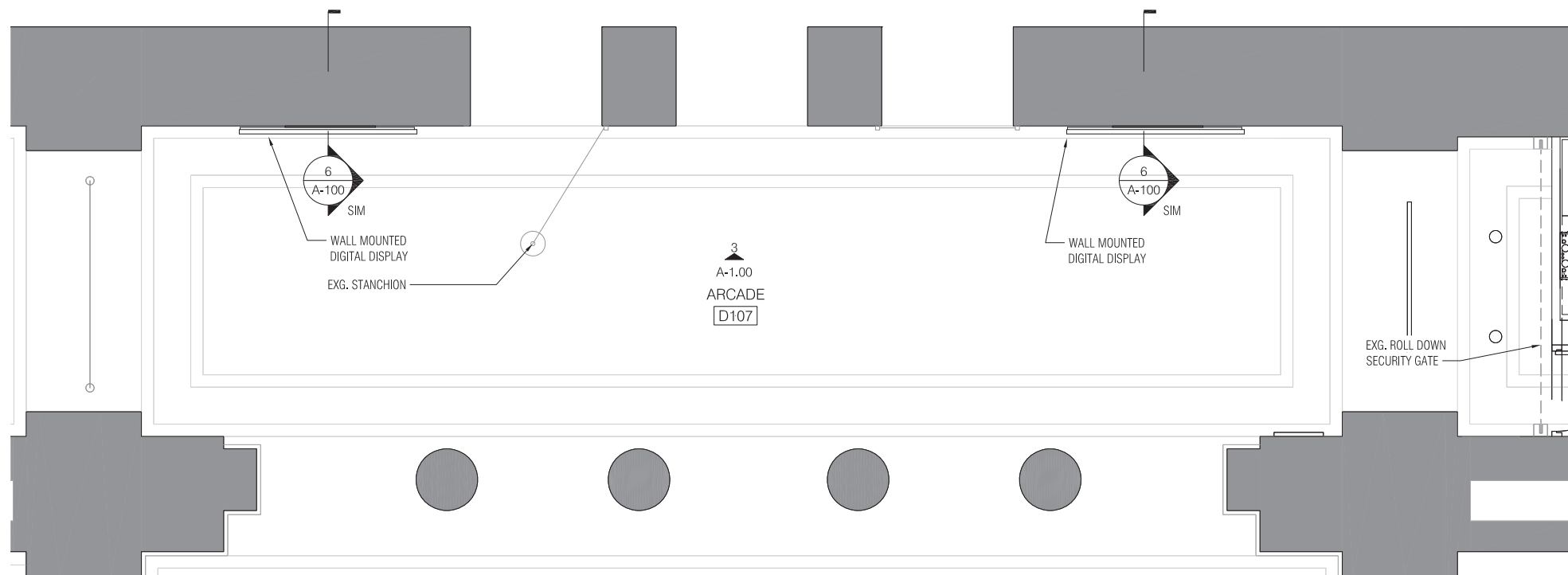





PHOTO OF GREAT HALL WITH TEMPORARY DISPLAY SCREEN INSTALLATION UNDER THE FAR BALCONY, LOOKING SOUTH



PHOTO OF TEMPORARY DISPLAY SCREEN INSTALLATION, LOOKING NORTH

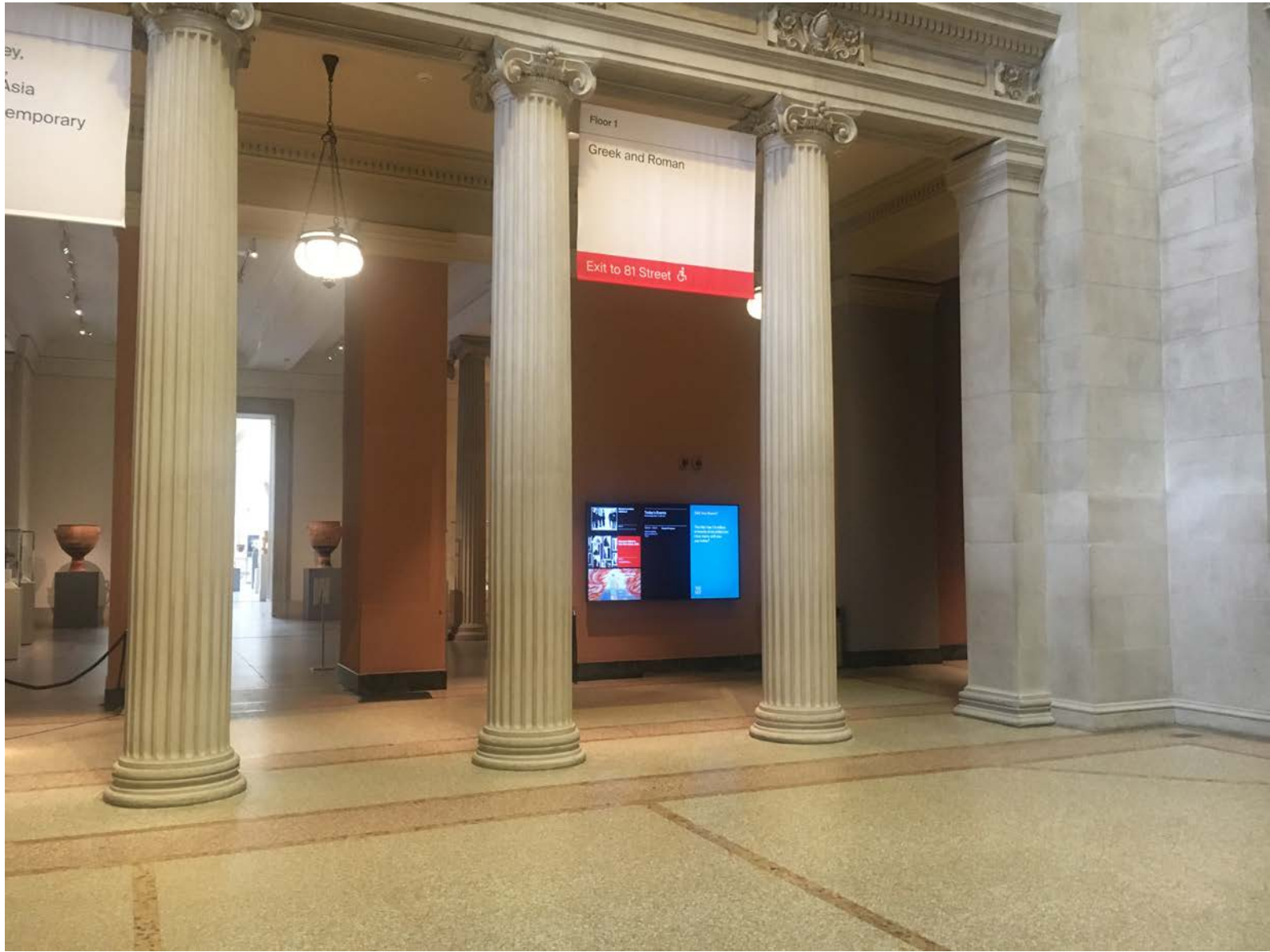

PHOTO OF TEMPORARY DISPLAY SCREEN INSTALLATION, LOOKING SOUTH

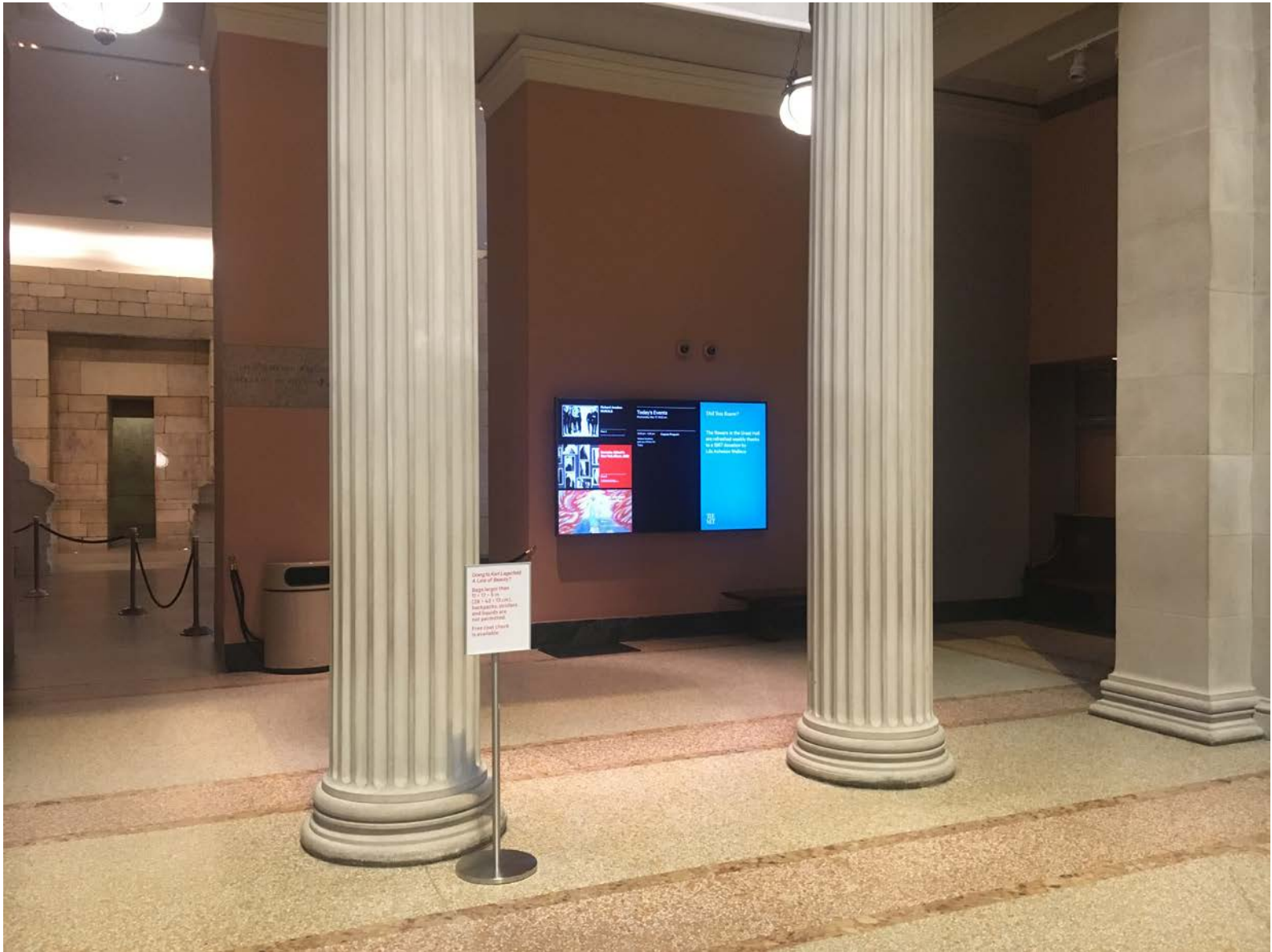

PHOTO OF TEMPORARY DISPLAY SCREEN INSTALLATION, LOOKING NORTH



PHOTO OF TEMPORARY DISPLAY SCREEN INSTALLATION AT SOUTH PASSAGE



PHOTO OF EXISTING TEMPORARY DISPLAY SCREEN INSTALLATION, LOOKING NORTH



PHOTO MONTAGE OF PROPOSED DISPLAY SCREEN INSTALLATION, LOOKING NORTH



PHOTO LOOKING INTO TICKETING HALL WITH EXISTING DISPLAY SCREENS



PHOTO OF EXISTING PORTABLE TICKET VENDING MACHINES

